



# Nexus™ Universal - Flexible & Simple Protocol

The Flexibility to Skip Steps with the Simplicity of Fewer Steps

## OptiBond FL

OptiBond™

Technique Guide

FL

### I. Phosphoric Acid Etch





Gel Etchant 00:00:15

00:00:10

### II. Primer Preparation

Unidose™      Bottle





### III. Primer Application





Unidose      Bottle

00:00:15

00:00:05



Store at ambient temperature





# Nexus™ Universal - Flexible & Simple Protocol

The Flexibility to Skip Steps with the Simplicity of Fewer Steps

## OptiBond Solo Plus

OptiBond™

Solo Plus

### I. Phosphoric Acid Etch



Gel Etchant 00:00:15



00:00:10



00:00:05

### II. Adhesive Preparation

Unidose™



00:00:05

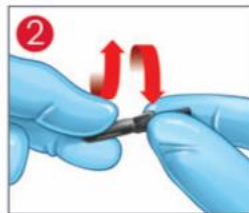

Bottle



00:00:05





# Nexus™ Universal - Flexible & Simple Protocol

The Flexibility to Skip Steps with the Simplicity of Fewer Steps

## OptiBond Solo Plus

Technique Guide



### III. Adhesive Application



00:00:15



00:00:05



Demi™  
Demi™ Plus  
Demi™ Ultra } 00:00:10

Store at ambient temperature





# Nexus™ Universal - Flexible & Simple Protocol

The Flexibility to Skip Steps with the Simplicity of Fewer Steps

## OptiBond eXTRa Universal

OptiBond™

eXTRa Universal

### I. Adhesive Preparation

#### Primer



Unidose™

#### Adhesive



00:00:05



#### Primer



Bottle



#### Adhesive



00:00:05





# Nexus™ Universal - Flexible & Simple Protocol

The Flexibility to Skip Steps with the Simplicity of Fewer Steps

## OptiBond eXTRa Universal

Technique Guide

### II. Product Application

#### Primer



00:00:20



00:00:05



#### Adhesive



00:00:15



00:00:05



Demi™  
Demi™ Plus  
Demi™ Ultra — 00:00:10





# Nexus™ Universal - Flexible & Simple Protocol

The Flexibility to Skip Steps with the Simplicity of Fewer Steps

## OptiBond Universal

OptiBond™

Technique Guide

Universal

### I. Adhesive Preparation

Unidose™



00:00:10



Bottle



00:00:10



### II. Adhesive Application



00:00:20



00:00:20



00:00:05



Demi™  
Demi™ Plus  
Demi™ Ultra } 00:00:10

2°C (36°F) } 8°C (46°F) }